

**FOR SALE
OR LEASE**

930 SF - 8,000 SF | Yucaipa, CA | Professional & Medical Office Suites

Presented by Strata Realty | www.stratarealty.com | T (951)280-1733 | F (951) 280-1739



930 SF - 8,000 SF PROFESSIONAL & MEDICAL OFFICE SUITES

Location

34675 Yucaipa Blvd.
Yucaipa, CA 92399

Features

- Separately metered
- Private rest rooms inside suites
- Peaceful courtyard garden
- 4:1 parking ratio
- Major street frontage
- Nearby shopping centers and retail amenities
- Professionally managed
- Broker Co-Op



Contact:

Timothy Hawke, SIOR

(951) 280-1733 | thawke@stratarealty.com

Jason Palda

(951) 280-1733 | jpalda@stratarealty.com

**FOR SALE
OR LEASE**

930 SF - 8,000 SF | Yucaipa, CA | Professional & Medical Office Suites

Contact: Timothy Hawke or Jason Palda | T (951) 280-1733

SITE MAPS

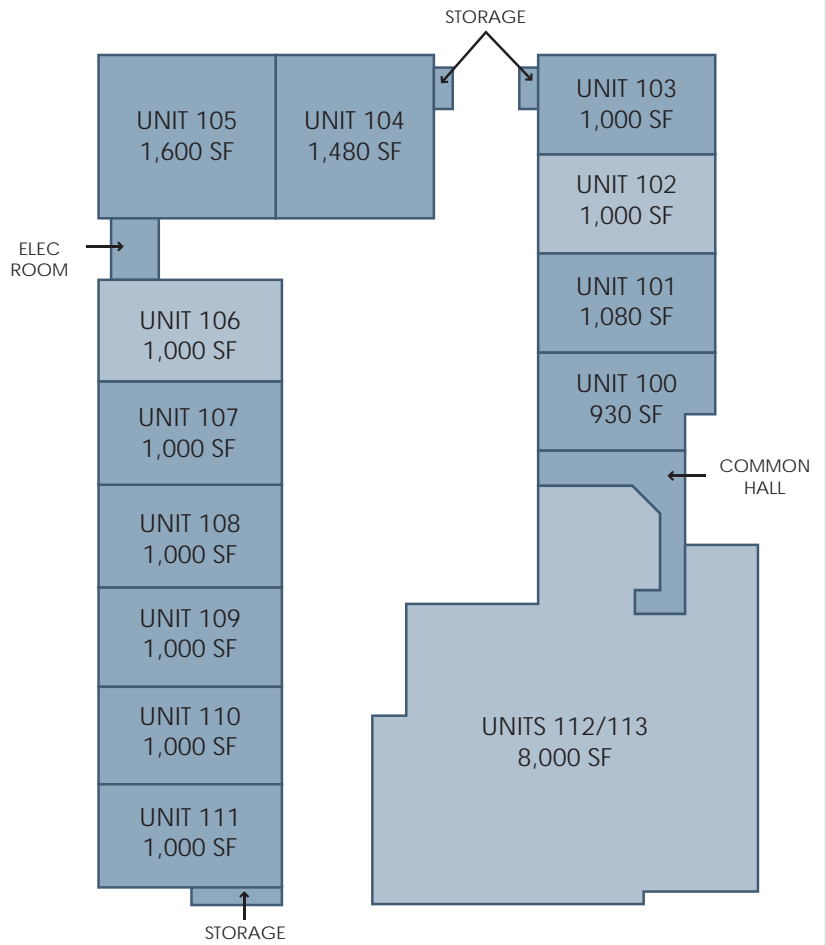
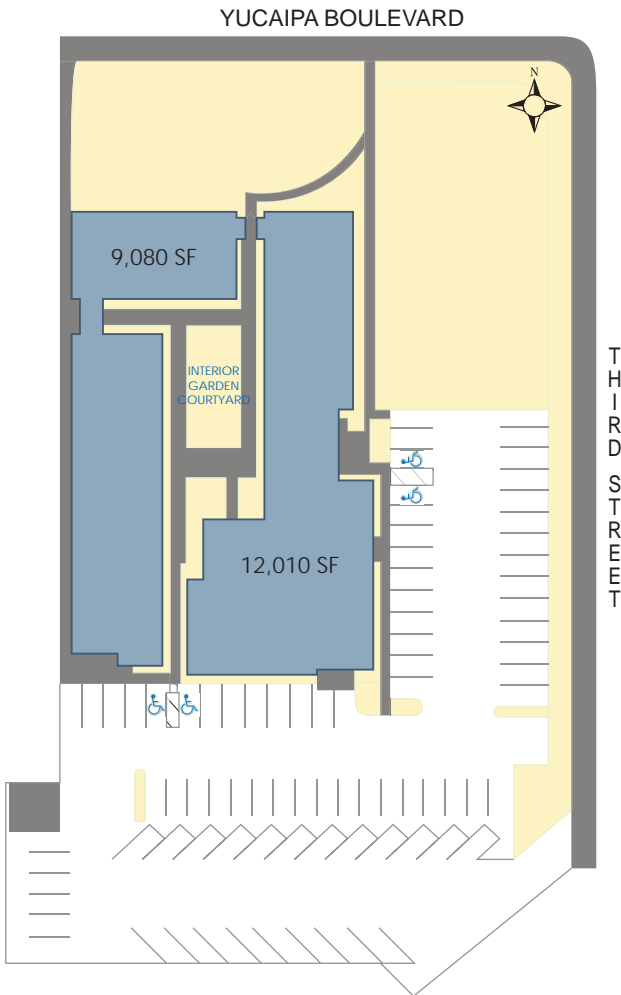

= Available = Not Available