

**FOR LEASE**

1,244 - 3,898 SF | Corona, CA | Multi-tenant Industrial Park

Presented by Strata Realty, Inc. | [www.stratarealty.com](http://www.stratarealty.com) | T (951) 280-1733 | F (951) 280-1739



## FLEXIBLE ZONING

### 1,244 - 3,898 SF MULTI-TENANT INDUSTRIAL PARK

#### Location

271 Ott Street  
Corona, CA 92880

#### Features

- Part of a 3.52 acre mixed-use business park
- One (1) ground level door per unit
- 100 amps of power per unit
- Private restrooms
- 18' clear height
- Beautifully landscaped and maintained
- Several restaurants and retail amenities nearby
- Convenient access to 91 and I-15 freeways

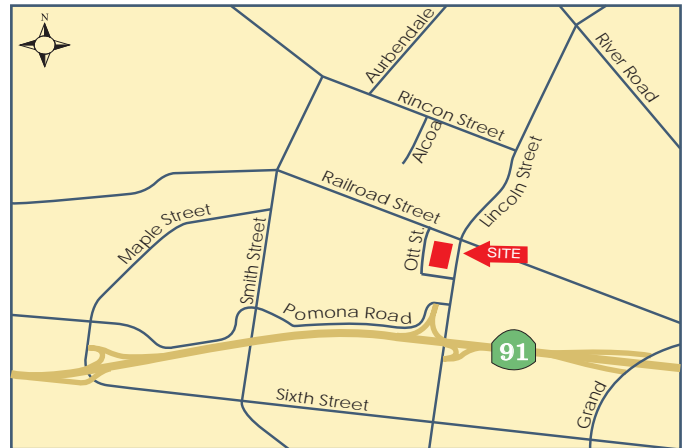

#### Contact:

##### Timothy Hawke, SIOR

(951) 280-1733 | [thawke@stratarealty.com](mailto:thawke@stratarealty.com)

##### Jason Palda

(951) 280-1733 | [jpalda@stratarealty.com](mailto:jpalda@stratarealty.com)

##### Landon Hawke

(951) 280-1733 | [lhawke@stratarealty.com](mailto:lhawke@stratarealty.com)

**FOR LEASE**

1,244 - 3,898 SF | Corona, CA | Multi-tenant Industrial Park

Contact: Tim Hawke, Jason Palda, or Landon Hawke | T (951) 280-1733

**SITE PLAN**

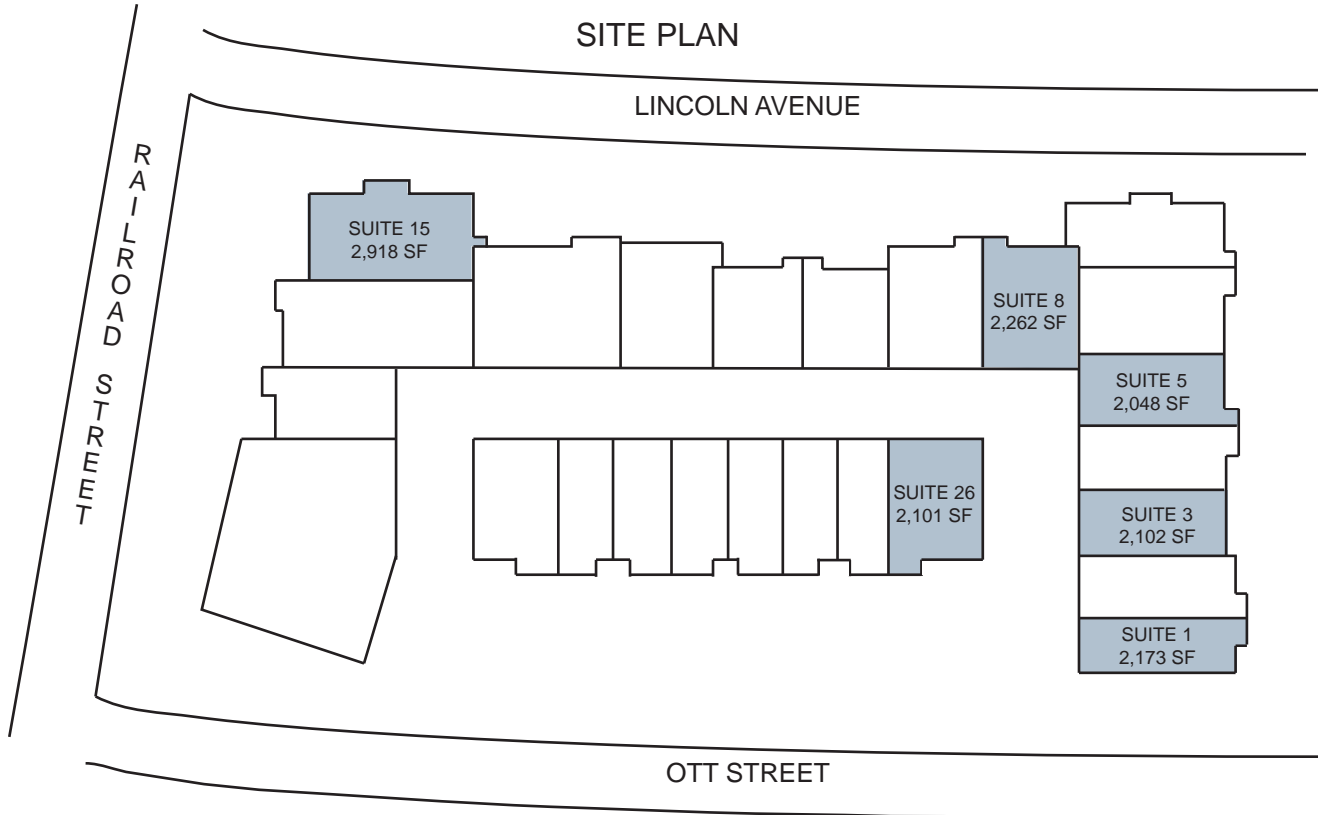

Current Office Availabilities

Address	Availability (SF)
268 N. Lincoln Avenue, Suite 1	2,173
268 N. Lincoln Avenue, Suite 3	2,102
268 N. Lincoln Avenue, Suite 5	2,048
268 N. Lincoln Avenue, Suite 8	2,262
268 N. Lincoln Avenue, Suite 15	2,918

Current Industrial Availabilities

Address	Availability (SF)
271 Ott Street, Suite 26	2,101