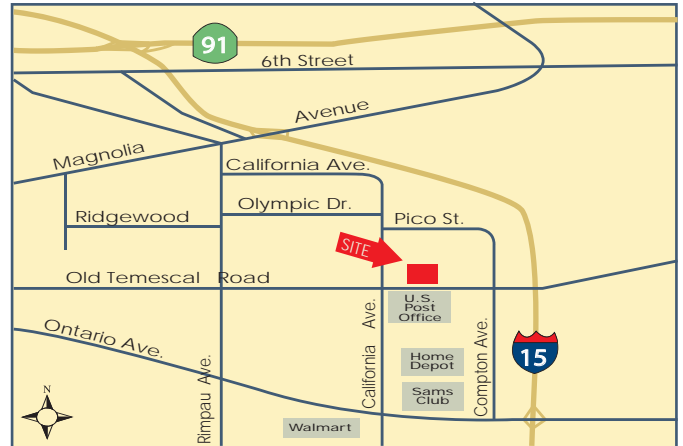

**FOR LEASE****2,416 SF | Corona, CA | High-Image Office Suite**Presented by Strata Realty, Inc. | [www.coronaspectrum.com](http://www.coronaspectrum.com) | T (951) 280-1733 | F (951) 280-1739**2,416 SF HIGH-IMAGE OFFICE SUITE**  
**NO ASSOCIATION FEES!!****Location**1365 Old Temescal Road, Suite 101  
Corona, CA 92881**Features**

- Professional Business Park Environment
- Major Street Frontage
- T-1 and DSL lines available
- Two (2) private offices
- Common area restrooms
- 4:1 parking ratio
- 100% reserved parking
- M-4 zoning
- Directly across from the South Corona post office and within walking distance to many retail amenities nearby
- Great access to 91 and I-15 freeways

**Contact:****Timothy Hawke, SIOR**(951) 280-1733 | [thawke@stratarealty.com](mailto:thawke@stratarealty.com)**Landon Hawke**(951) 280-1733 | [lhawke@stratarealty.com](mailto:lhawke@stratarealty.com)**Jason Palda**(951) 280-1733 | [jpalda@stratarealty.com](mailto:jpalda@stratarealty.com)**DRE Information**Timothy Hawke's license number is 01403432  
Landon Hawke's license number is 01770844  
Jason Palda's license number is 01820370

**FOR LEASE**

2,416 SF | Corona, CA | High-Image Office Suite

Contact: **Tim Hawke, Landon Hawke, or Jason Palda** | [www.coronaspectrum.com](http://www.coronaspectrum.com) | T (951) 280-1733

**FLOOR PLAN**

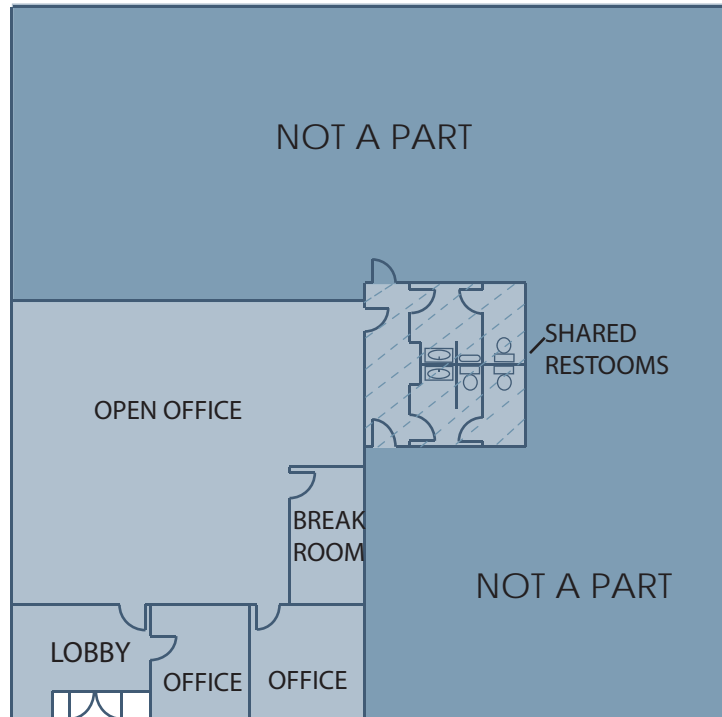

**SITE PLAN**



**DRE Information**