

FOR LEASE**2,131 SF | Corona, CA | High-Image, Office Suite Part of a Larger Free-Standing Building**Presented by Strata Realty, Inc. | www.stratarealty.com | T (951) 280-1733 | F (951) 280-1739**2,131 SF OFFICE SUITE, PART OF A LARGER 4,595 SF FREE-STANDING OFFICE BUILDING****Location**1881 California Avenue
Corona, CA 92881**Features**

- High impact lobby with natural stone flooring
- Three (3) private offices
- Break room
- Oversized conference room
- 10' ceilings throughout
- Operable windows and window shades
- Private Men's and Women's restrooms
- Fountain views
- 4:1 parking ratio
- Desirable south Corona location
- Within walking distance to many retail amenities nearby
- Great access to 91 and I-15 freeways

**Contact:****Timothy Hawke, SIOR**
(951) 280-1733 | thawke@stratarealty.com

FOR LEASE

2,131 SF | Corona, CA | High-Image, Office Suite Part of a Larger Free-Standing Building

Contact: Tim Hawke | T (951) 280-1733

FLOOR PLAN

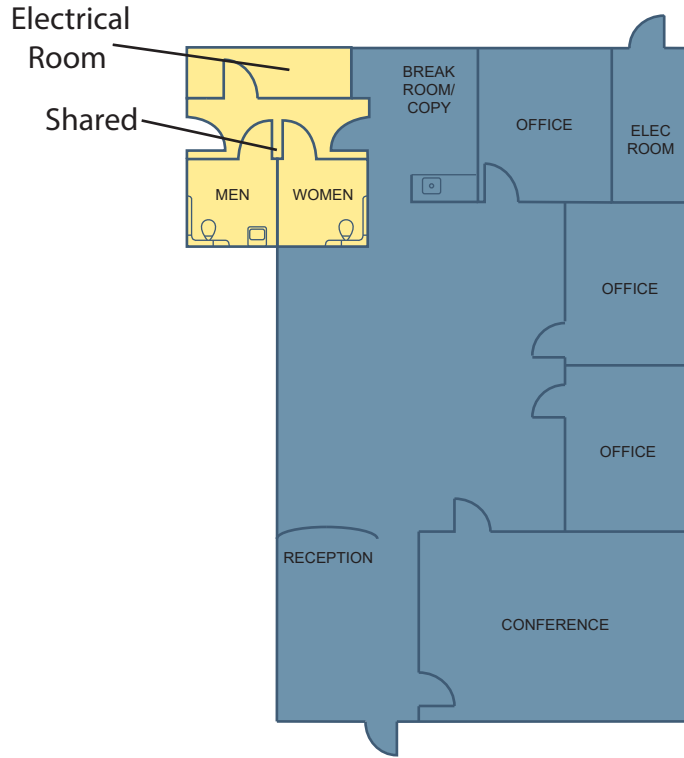

SITE PLAN

