

FOR LEASE

5,145 SF | Corona, CA | High-Image Office Suite

Presented by Strata Realty, Inc. | www.stratarealty.com | T (951) 280-1733**5,145 SF HIGH-IMAGE OFFICE SUITE****Location**1861 California Avenue, Suite 101
Corona, CA 92881**Features**

- Part of a 10 acre master-planned office park
- Highly upgraded tenant improvements, plug and play space-ready for occupancy
- Dramatic reception area with 14 foot ceiling
- Hurculite glass conference room doors
- Three (3) private offices
- Break room with sink and disposal
- Men's and Women's restrooms
- Directly across from the South Corona post office and within walking distance to many retail amenities nearby
- Great access to 91 and I-15 freeways

**Contact:****Timothy Hawke, SIOR**(951) 280-1733 | thawke@stratarealty.com

FOR LEASE

5,145 SF | Corona, CA | High-Image Office Suite

Contact: Tim Hawke | T (951) 280-1733

FLOOR PLAN

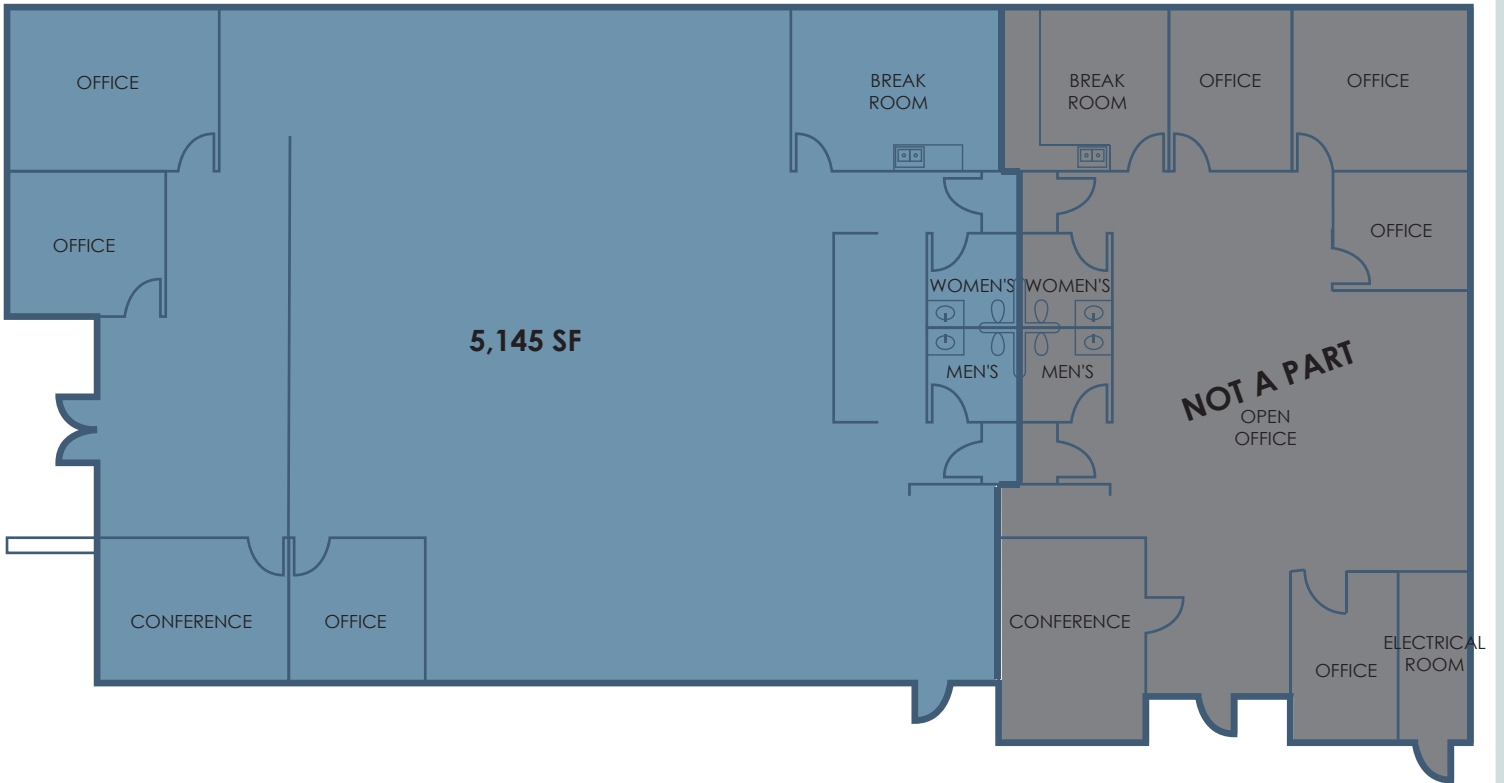

SITE PLAN

