

FOR LEASE**4,303 SF | Corona, CA | Free-Standing, High-Image Single Story Office Building**Presented by Strata Realty, Inc. | www.stratarealty.com | T (951) 280-1733 | F (951) 280-1739**4,303 SF FREE-STANDING OFFICE BUILDING****Location**1885 California Avenue
Corona, CA 92881**Features**

- Part of a 10 acre master-planned office park
- Dramatic reception area
- Climate controlled server room
- Four (4) private offices
- Concrete construction with courtyard and two (2) private fountains
- Separate Men's and Women's restrooms
- Coffee bar/break room area
- Directly across from the South Corona post office and within walking distance to many retail amenities nearby
- Great access to 91 and I-15 freeways

**Contact:****Timothy Hawke, SIOR**(951) 280-1733 | thawke@stratarealty.com**Angela Draper**(951) 280-1733 | adraper@stratarealty.com**BRE Information**Timothy Hawke's license number is 01403432
Angela Draper's license number is 01972882

FOR LEASE

4,303 SF | Corona, CA | Free-Standing, High-Image Single Story Office Building

Contact: Tim Hawke or Angela Draper | T (951) 280-1733

FLOOR PLAN

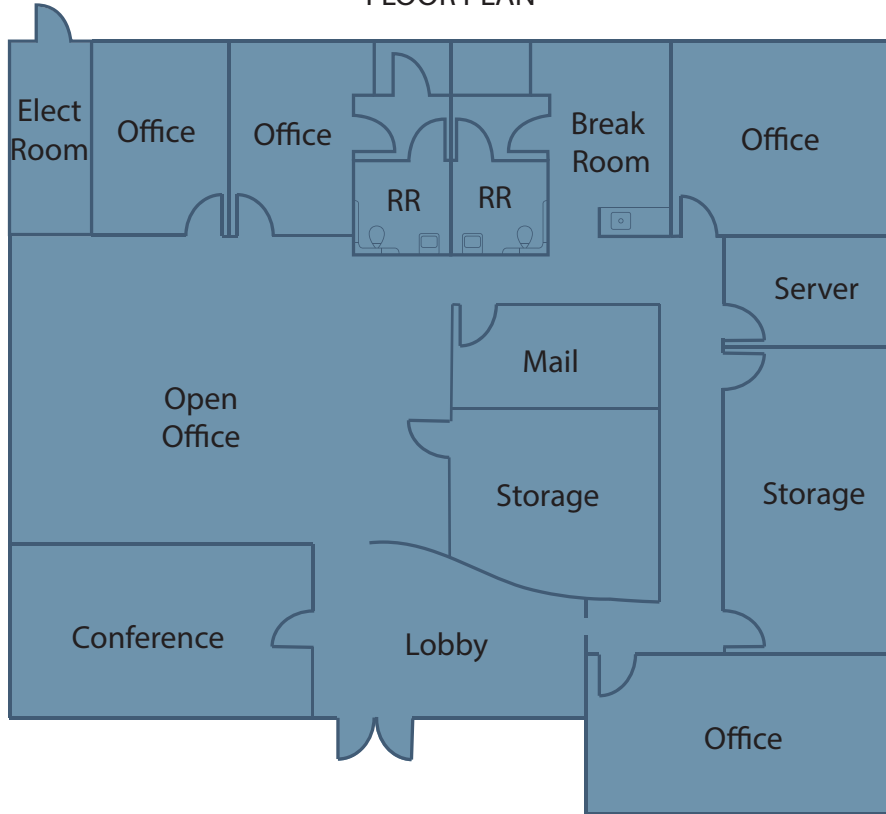

SITE PLAN

