

FOR LEASE

1,319 - 8,658 SF | Corona, CA | Professional Office Suites

Presented by Strata Realty, Inc. | www.stratarealty.com | T (951) 280-1733 | F (951) 280-1739



1,319 - 8,658 SF PROFESSIONAL OFFICE/INDUSTRIAL SUITES

Location

268 North Lincoln Avenue
271 Ott Street
Corona, CA 92880

Features

- Part of a 3.52 acre mixed-use business park
- Great visibility on Lincoln Avenue
- Over 20,000 commuters pass by each day
- Private restrooms
- Reception area and private offices
- Fully built-out office suites
- Server rooms
- Flexible BL-2 zoning
- Beautifully landscaped and maintained
- Several restaurants and retail amenities nearby
- Convenient access to 91 and I-15 freeways

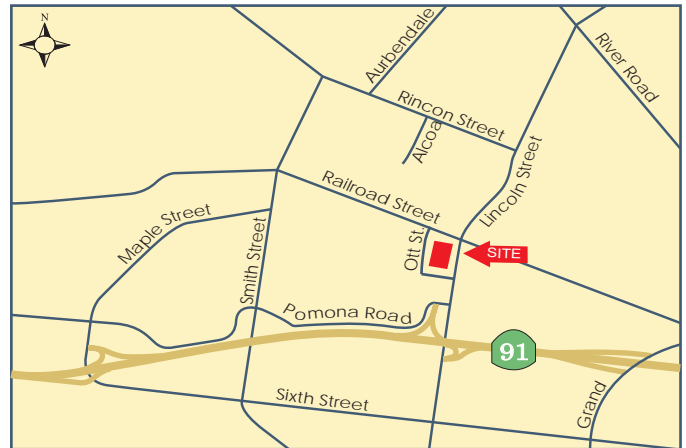

Contact:

Timothy Hawke, SIOR

(951) 280-1733 | thawke@stratarealty.com

Angela Draper

(951) 280-1733 | adraper@stratarealty.com

FOR LEASE

1,319 - 8,658 SF | Corona, CA | Professional Office Suites

Contact: Tim Hawke or Angela Draper | T (951) 280-1733

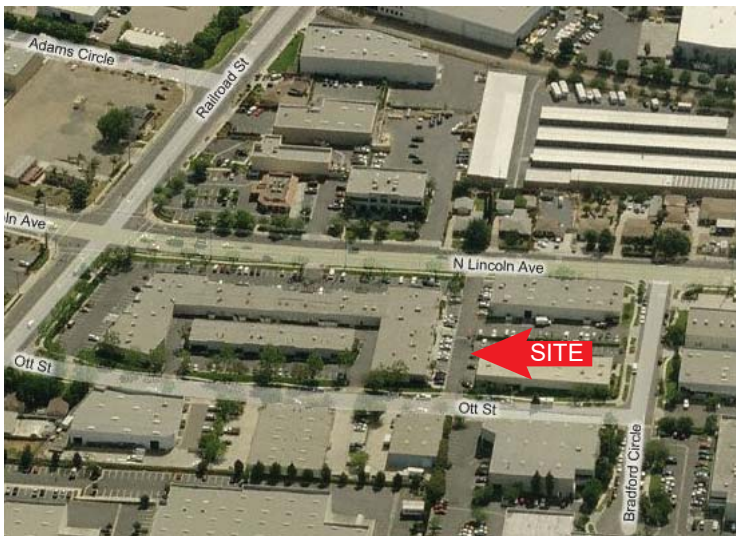
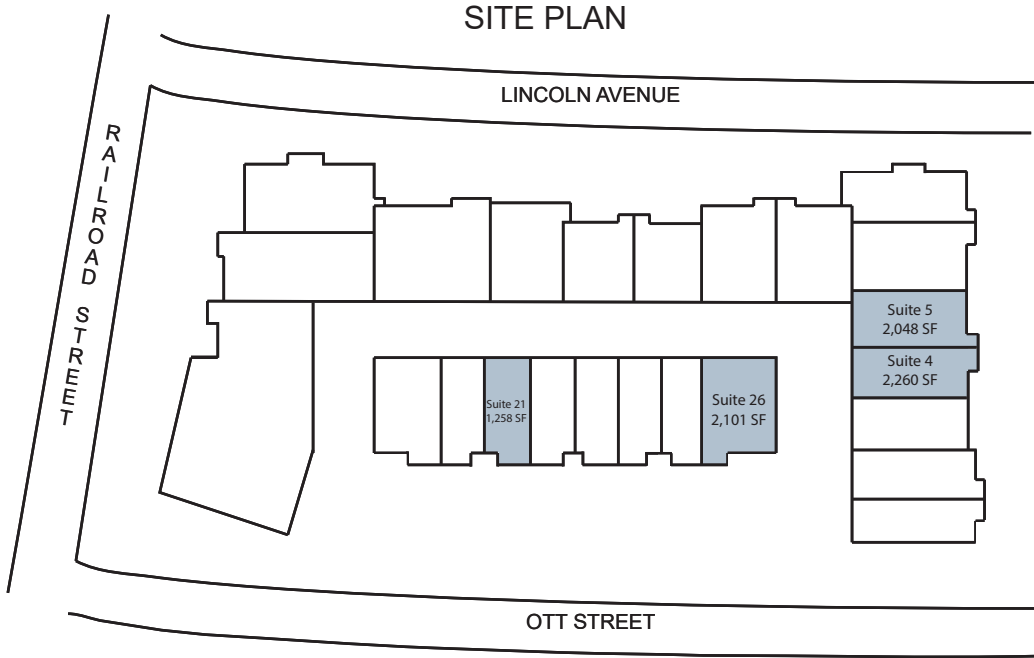

Current Office Availabilities

Address	Availability (SF)
268 N. Lincoln Avenue, Suite 4	2,260
268 N. Lincoln Avenue, Suite 5	2,048

Current Industrial Availabilities

Address	Availability (SF)
271 N. Ott Street, Suite 21	1,258
271 N. Ott Street, Suite 26	2,101