

**FOR LEASE**

1,319 - 8,658 SF | Corona, CA | Professional Office Suites

Presented by Strata Realty, Inc. | [www.stratarealty.com](http://www.stratarealty.com) | T (951) 280-1733 | F (951) 280-1739**1,319 - 8,658 SF PROFESSIONAL OFFICE/INDUSTRIAL SUITES****Location**

268 North Lincoln Avenue  
271 Ott Street  
Corona, CA 92880

**Features**

- Part of a 3.52 acre mixed-use business park
- Great visibility on Lincoln Avenue
- Over 20,000 commuters pass by each day
- Private restrooms
- Reception area and private offices
- Fully built-out office suites
- Server rooms
- Flexible BL-2 zoning
- Beautifully landscaped and maintained
- Several restaurants and retail amenities nearby
- Convenient access to 91 and I-15 freeways

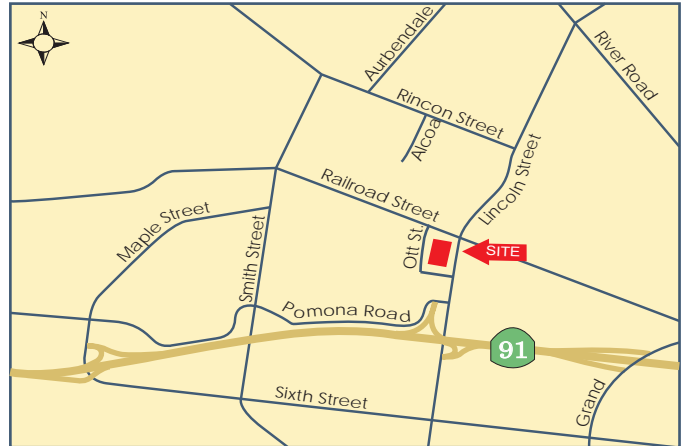
**Contact:****Timothy Hawke, SIOR**(951) 280-1733 | [thawke@stratarealty.com](mailto:thawke@stratarealty.com)**Jared Carver**(951) 280-1733 | [jcarver@stratarealty.com](mailto:jcarver@stratarealty.com)

**FOR LEASE**

1,319 - 8,658 SF | Corona, CA | Professional Office Suites

Contact: Tim Hawke or Jared Carver | T (951) 280-1733

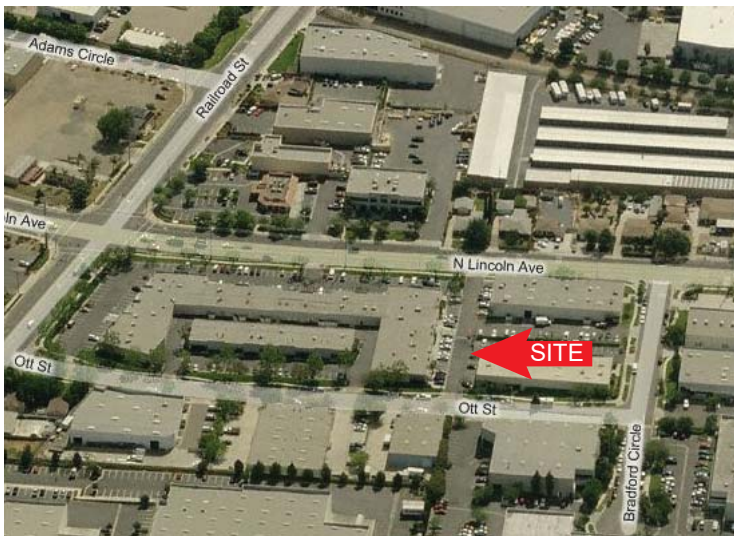
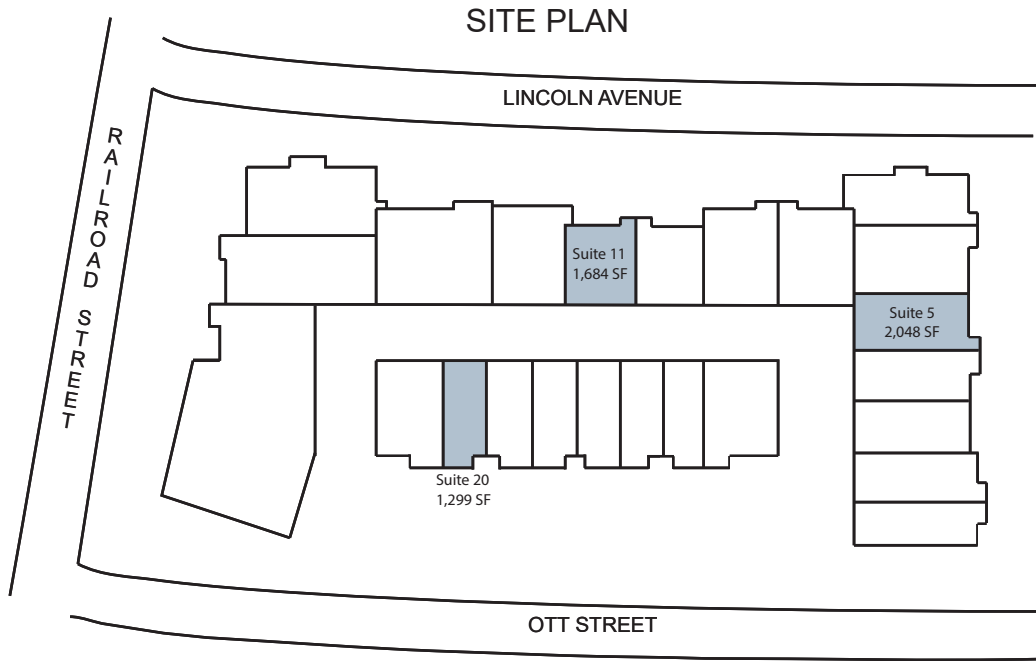

Current Office Availabilities

Address	Availability (SF)
268 N. Lincoln Avenue, Suite 5	2,048
268 N. Lincoln Avenue, Suite 11	1,684

Current Industrial Availabilities

Address	Availability (SF)
271 N. Ott Street, Suite 20	1,299