

**FOR
LEASE**

15,660 SF | Corona, CA | Industrial Building for Lease

Presented by Strata Realty, Inc. | www.stratarealty.com | T (951) 280-1733 | F (951) 280-1739

Industrial Building for Lease

Location

272 Corporate Terrace Circle
Corona, CA 92879

Features

- One (1) 12' x 14' GL Door
- One (1) 14' x 14' GL Door
- Two (2) 9' x 10' DH Doors
- Approximately 2,000 SF Office
- 24' Clear Height
- 3% Skylights
- .45 GPM/3,000 SF Fire Sprinkler System
- 800 Amps 277/480 Volts
- M-2 Zoning
- 2:1 Parking Ratio
- Large Fenced Yard Area
- Great Access to the I-15 and 91 Freeways

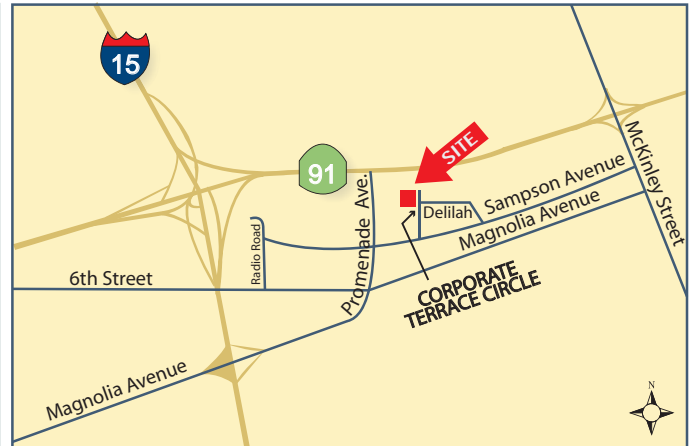

Contact:

Timothy Hawke, SIOR
(951) 280-1733 | thawke@stratarealty.com

**FOR
LEASE**

15,660 SF | Corona, CA | Industrial Building for Lease

Contact: Timothy Hawke | T (951) 280-1733

FLOOR PLAN

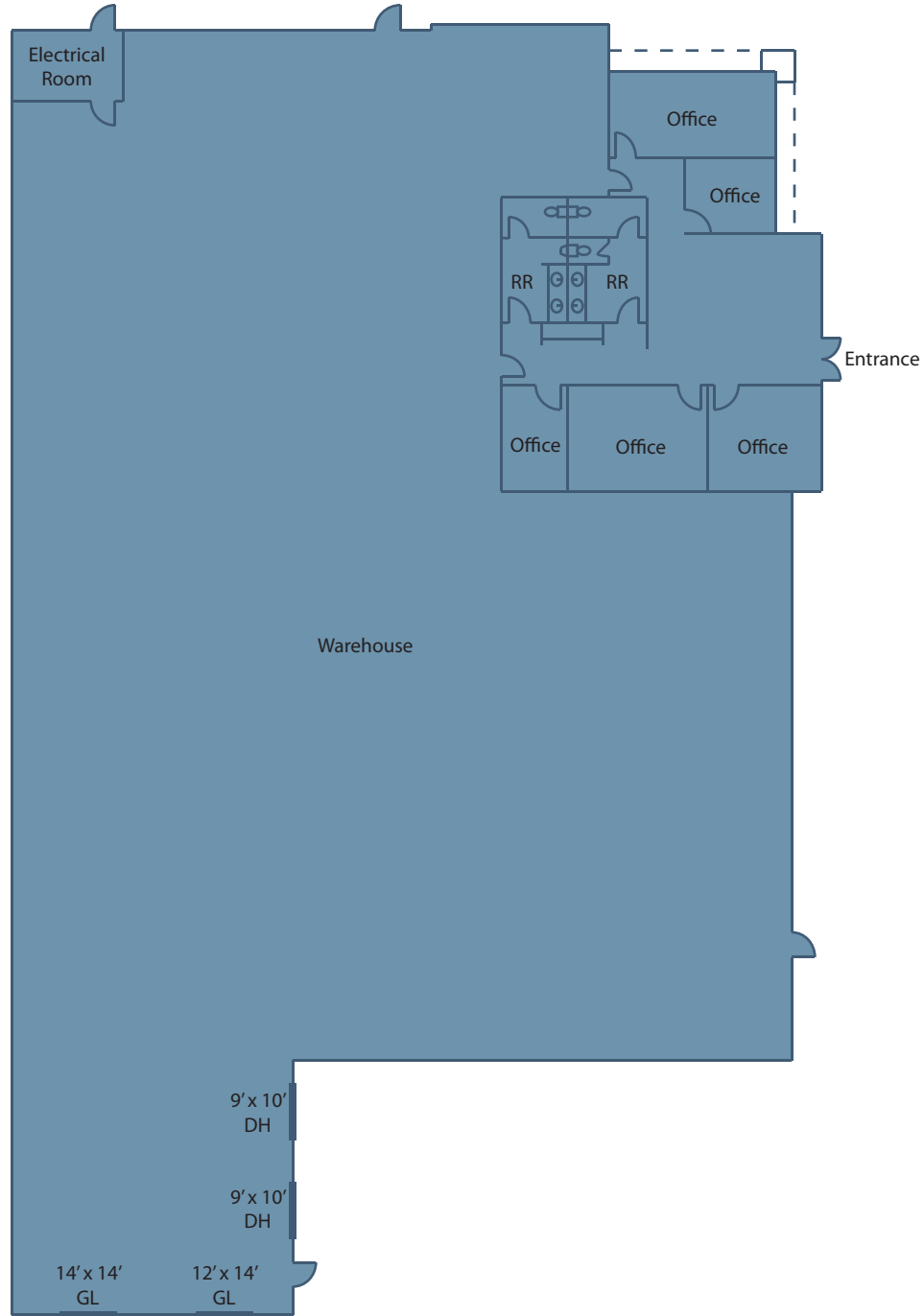

**FOR
LEASE**

15,660 SF | Corona, CA | Industrial Building for Lease

Contact: Timothy Hawke | T (951) 280-1733

AERIAL

