

**FOR SALE
OR LEASE**

28,254 SF | Corona, CA | High-Image Office Building

Presented by Strata Realty, Inc. | www.stratarealty.com | T (951) 280-1733 | F (951) 280-1739



28,254 SF HIGH-IMAGE OFFICE BUILDING

Location

1801 California Avenue
Corona, CA 92881

Features

- High Image, 2-Story Corporate Office Building
- Approximately 3,254 Sq. Ft. Warehouse
- Four (4) T1 Lines Running Into Building
- One (1) T1 Line Running Out of Building
- Secure Server Room with Dual HVAC Service
- Ample Parking with a Secured Gated Parking Area Possible
- Abundant Window Lines
- Potentially Divisible for Multi-Tenants
- Ideal Call Center Facility Which Conforms to Existing Use
- Building Signage Available
- Easy Access to Orange, San Diego, Los Angeles, and San Bernardino Counties
- Desirable Corona Location with Easy Freeway Access



Contact:

Timothy Hawke, SIOR
(951) 280-1733 | thawke@stratarealty.com

**FOR SALE
OR LEASE**

28,254 SF | Corona, CA | High-Image Office Building

Contact: Tim Hawke | T (951) 280-1733

FLOOR PLAN

First Floor



Second Floor

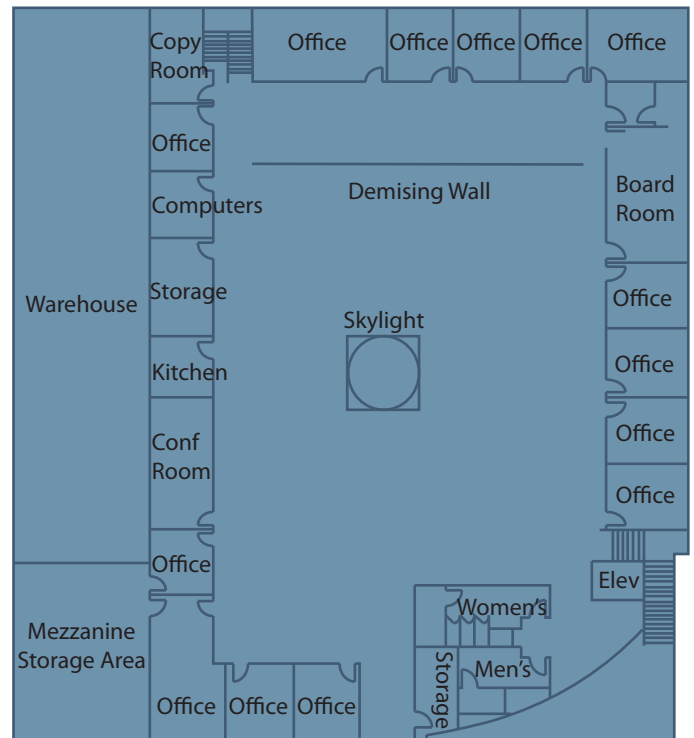

**FOR SALE
OR LEASE**

28,254 SF | Corona, CA | High-Image Office Building

Contact: Tim Hawke | T (951) 280-1733

AERIAL

